

Let's get started



For important safety & warranty information, please refer to the Safety and Warranty Information linked from your phone or visit the Kyocera website at kyoceramobile.com/support/phone and select your phone.

AT&T Eco Rating 2.0 only applies to E4830. For limited factors evaluated visit att.com/EcoSpace. Wireless Emergency Alerts is a registered Trademark and Service Mark of CTIA.

© 2021 Kyocera Corporation. All rights reserved. Kyocera and the Kyocera logo are registered trademarks of Kyocera Corporation. DuraXE Epic is a trademark of Kyocera International, Inc. All other trademarks are the property of their respective owners. Contains Li-ion battery - recycle or dispose of properly. © 2021 AT&T Intellectual Property. All rights reserved. AT&T, the AT&T logo and all other AT&T marks contained herein are trademarks of AT&T Intellectual Property. All other marks are the property of their respective owners.



Features

- IP68 dust proof and waterproof (up to 6.5 ft for 30 min), and MIL-STD 810H durability
- Loud 100dB+ dual front speakers to hear and be heard clearly
- 1770mAh battery and USB Type-C charging
- Multi-use charging contacts
- Large, tactile glove-friendly keypad and buttons
- Dedicated PTT, SOS, External speaker, and Call list keys are also user-programmable to access other functions
- 2-year standard manufacturer's warranty
- Mobile Hotspot* (Up to 10 connections)

*Use of this service requires a compatible data plan. Check your plan.

Useful Apps*



AT&T Enhanced Push-to-Talk

Go beyond voice and collaborate with your field workers at the push of a button.

Set Up EPTT

1. Press and hold the PTT key.
2. Press the Left soft key **[Yes]**.
3. Highlight **AT&T EPTT** and press the Center soft key **[Set]**.
4. Press the PTT key again, and then follow the on-screen instructions.

What else is in the box?

- Phone
- Removable Li-Ion battery
- AC adapter (Type-C USB data cable pluggable)
- Type-C USB data cable
- Pre-installed SIM card
- Let's Get Started Guide

Find More Information

Manage Your Account with myAT&T

- On your phone: **Menu > AT&T > myAT&T**
- On the web: att.com/myATT



Compatible device and online account required. Data and messaging rates may apply for download and app usage.

Need More Help?

- On your phone: **Menu > Browser > Options > Bookmarks/History > Device Help**
- On the web: att.com/DeviceHowTo



Give us a Call

- 611 from any AT&T wireless phone
- 800.331.0500 or prepaid 800.901.9878

*Compatible device and subscription may be required. Data and messaging rates may apply. Restrictions and limitations may apply. For more app information, go to <https://att.com/shop/apps>.

Your New Phone



Need more help?

Go to **Menu > Browser > Options > Bookmarks/History > Device Help**

*NOTE: The Camera feature is not available on all models.

Easily Adjust Settings

Settings Menu

Open the phone and press the Center soft key **[Menu]** > **Settings & tools** > **Settings**.

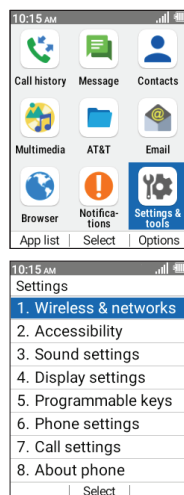

1. Scroll through on-screen items by using the navigation key up, down, left, or right. As you navigate through the menu, menu options are highlighted.
2. Select any option by highlighting it and pressing the Center soft key **[Select]**.
3. Repeat these steps until the menu item you want to use is displayed.

Capture Life's Moments

Take a Picture

1. Open the phone and press the Camera/Speaker key.
2. Press the Center soft key **[Take]** to take a picture.
 - Zoom in and out by pressing the Navigation key up and down.

Record a Video

1. Open the phone and press the Camera/Speaker key.
2. Press the Left soft key **[Record]** to begin recording.
3. Press the Center soft key **[Stop]** to stop recording.

Share a Picture or Video

1. Open the phone and press the Center soft key **[Menu]** > **Multimedia** > **Gallery**.
2. Select a picture or video and Press Right soft key **[Options]** > **Send**.
3. Select **Send one** or **Send multiple**.
4. Select a sharing method and follow the sending procedure.

*NOTE: The Camera feature is not available on all models.

How to replace the SIM

Install a SIM/ microSD

1. Remove the battery cover and the battery.
2. Lift the SIM/microSD guard tab by its edge until it stands up; then grip and pull the tab to flip open the guard.

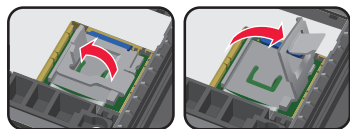

3. Push the SIM card gently with your finger and then release the pressure to take out the original SIM card. Insert the new SIM card carefully until it snaps into place.

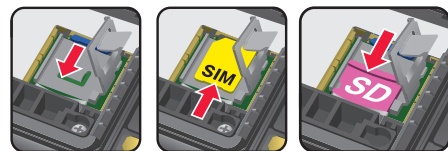

4. Slide the microSD card into the slot with the gold contacts facing down if necessary.
5. Place back the SIM/microSD guard and battery, and then close the battery cover firmly.

Turn on your new phone

Press and hold the END/POWER key until the screen lights up.

To turn your phone off, press and hold the END/POWER key until you see the powering-down animation on the main screen.

Call Family & Friends

Make a Call

1. Open the phone and enter a phone number.
2. Press the Center soft key **[Call]** or SEND key.
3. To end the call, press the END/POWER key.

Check Voicemail

1. Open the phone and press and hold 1 key.
2. If prompted, enter your voicemail password. Any new unheard messages will begin to play.
3. If you don't have new voicemail, press 1 key to listen to your saved messages.

Surf & Stream in no time

Connect to Wi-Fi

1. From the Settings screen, select **Wireless & networks** > **Wi-Fi** > **Wi-Fi**.
2. Highlight **On**, then press the Center soft key **[Set]**.
3. Highlight a Wi-Fi network you want to connect to and press the Center soft key **[Select]**.
4. Enter the password and press the Center soft key **[Save]**.

Use Bluetooth

1. From the Settings screen, select **Wireless & networks** > **Bluetooth** > **Bluetooth**.
2. Highlight **On**, then press the Center soft key **[Set]**.
3. Select **Pair new device**.
4. Select the device you want to connect to and follow the prompts to complete the pairing process.

Data rates may apply.